

REFERENCE	BT_2014_FR16_3_UK
DATE	04 July 2014
SUBJECT	Engine cover fitting points repair, damper displacement sensor and beacon receiver mounting details and cooling system blanking
PART	Engine cover, damper displacement sensor, beacon receiver, sidepod

## 1. Engine cover fitting points repair

It is allowed to repair the various fitting points of the engine cover in case of some threads have been damaged.

## 2. Damper displacement sensor mounting details

- Front suspension

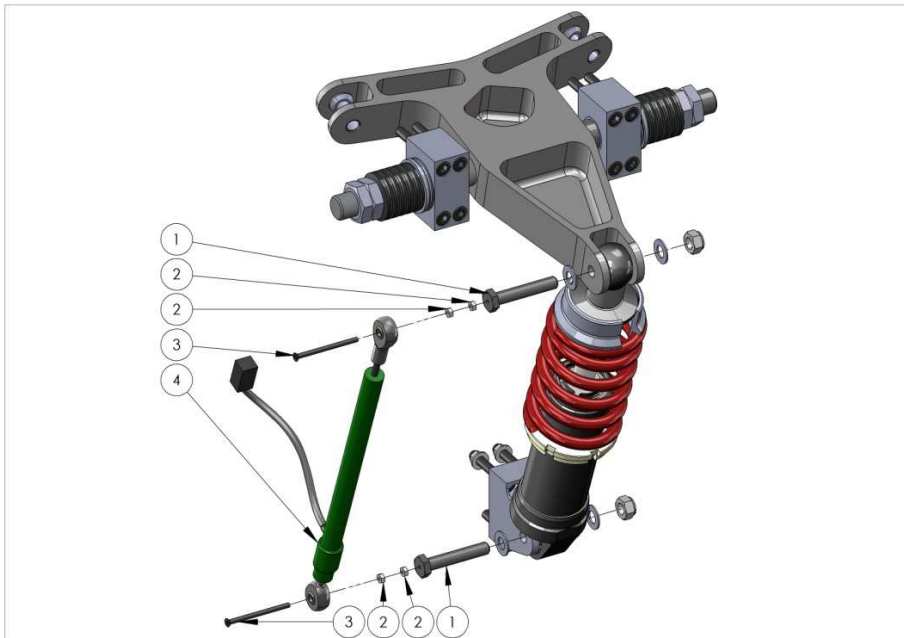

1. G04-17D017V1 Machined Screw for Damper Displacement Sensor
2. Nut H M3
3. FHC M3 x 45
4. G04-18A036V2 Damper Displacement Sensor with DTM connector

To mount the damper displacement sensor on the front rocker, replace the CHC M8 x 45 by the part "**G04-17D017V1 Machined Screw for Damper Displacement Sensor**". Use the nuts H M3 to tight the FHC M3 x 45 on the "**G04-17D017V1 Machined Screw for Damper Displacement Sensor**" and to avoid any contact between the sensor and the damper.

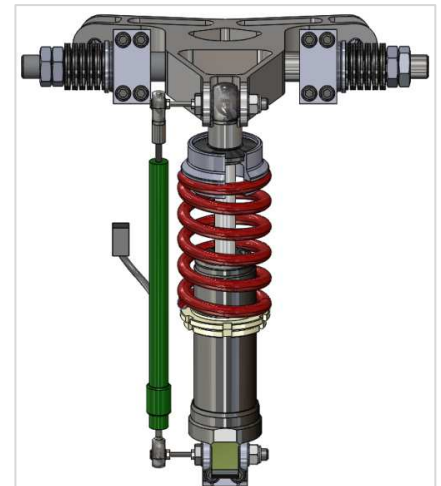

- Rear suspension

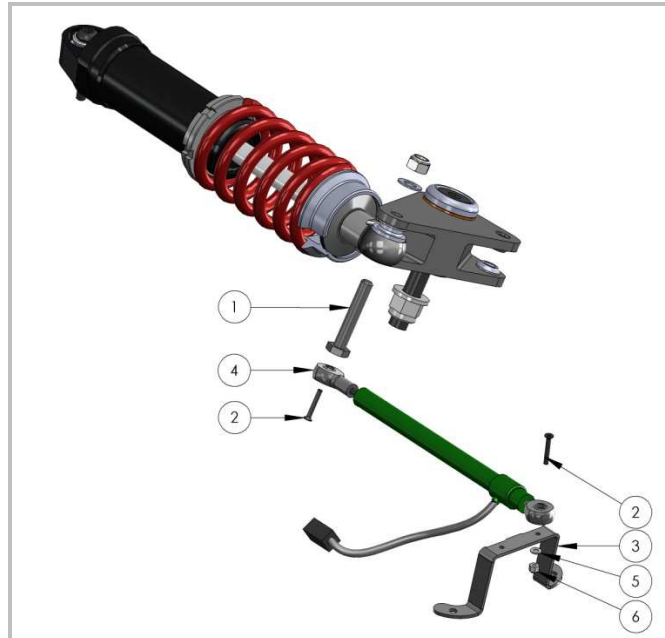

1. G04-17D017V1 Machined Screw for Damper Displacement Sensor
2. FHC M3 x 20
3. G04-16D013V1 Damper Displacement Sensor Support
4. G04-18A036V2 Damper Displacement Sensor with DTM connector
5. Flat Washer Ø3 x 10
6. Nylstop M3

To mount the damper displacement sensor on the rear rocker, replace the CHC M8 x 45 by the part "**G04-17D017V1 Machined Screw for Damper Displacement Sensor**". Place the part "**G04-16D013V1 Damper Displacement Sensor Support**" on the bell housing: use the two threaded holes (the closest to the back of the tub) used to mount the Catch Tank Hatch.

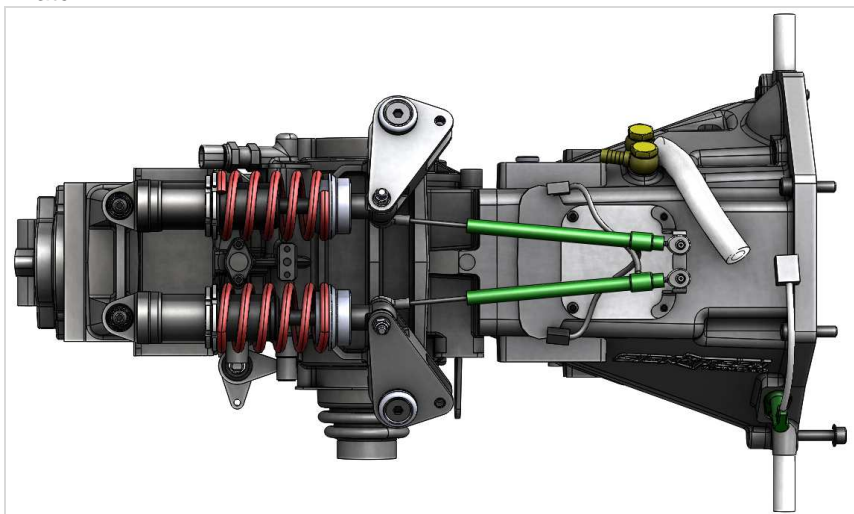

### 3 Beacon receiver mounting details

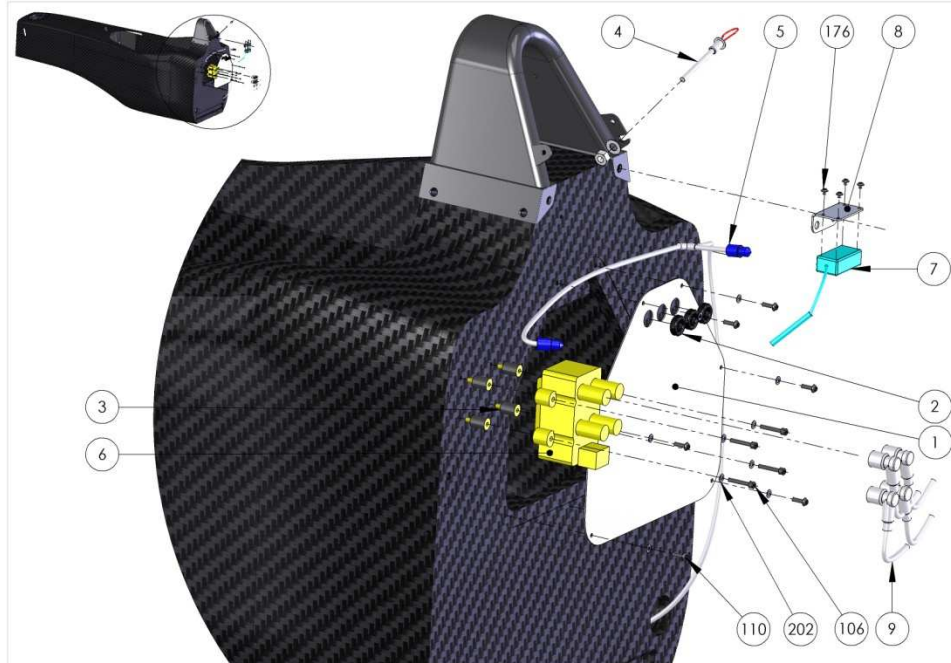

There is only one possible fitting position for the **G04-05B007V2 Beacon Receiver** (Rep. 7) in the car. It must be mounted on the part **G04-05B008V2 Beacon Bracket** (Rep.8) on the tub's back as shown in the picture.

It can be mounted on the right side or left side of the roll hoop depending of the position of the track beacon cell with the same part (reversible part).

*If the old version of the Beacon receiver (**G04-05B007V1 Beacon Receiver**) is used, you must only mount it on the **G04-05B008V1 Beacon Bracket**.*

#### 4 Cooling system blanking

Only blanking directly applied on the water radiator or on the water radiator nets are allowed. Any other blanking regarding the cooling system is forbidden (Tape directly applied on the sidepod bodywork is forbidden)

**REMINDER:**

It's allowed to fit the radiator nets onto the car following these points below:

- Radiator nets must be fitted inside the sidepod. Nets location is ruled between 5cm and 10cm behind the sidepod inlet section as shown in the picture below

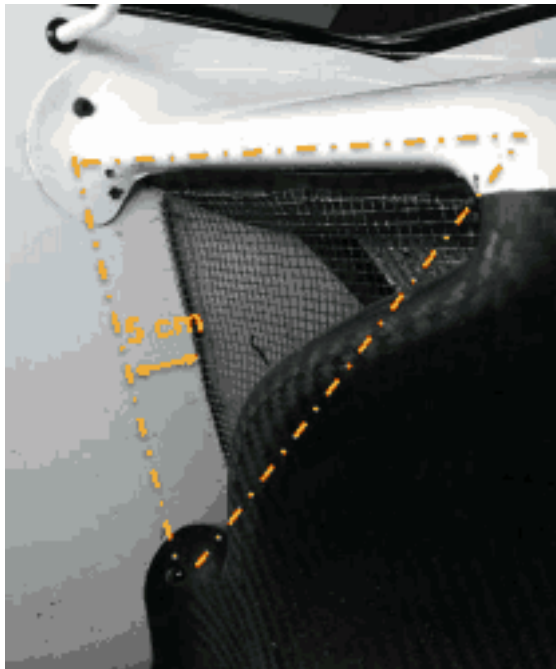

- Shape and dimensions of the nets are free